

APE TECH SHEET

AUTHORIZED DISTRIBUTOR FOR MIKUNI CARBURETORS AND PARTS

MIKUNI

VM 29 SMOOTH-BORE
CARBURETORS

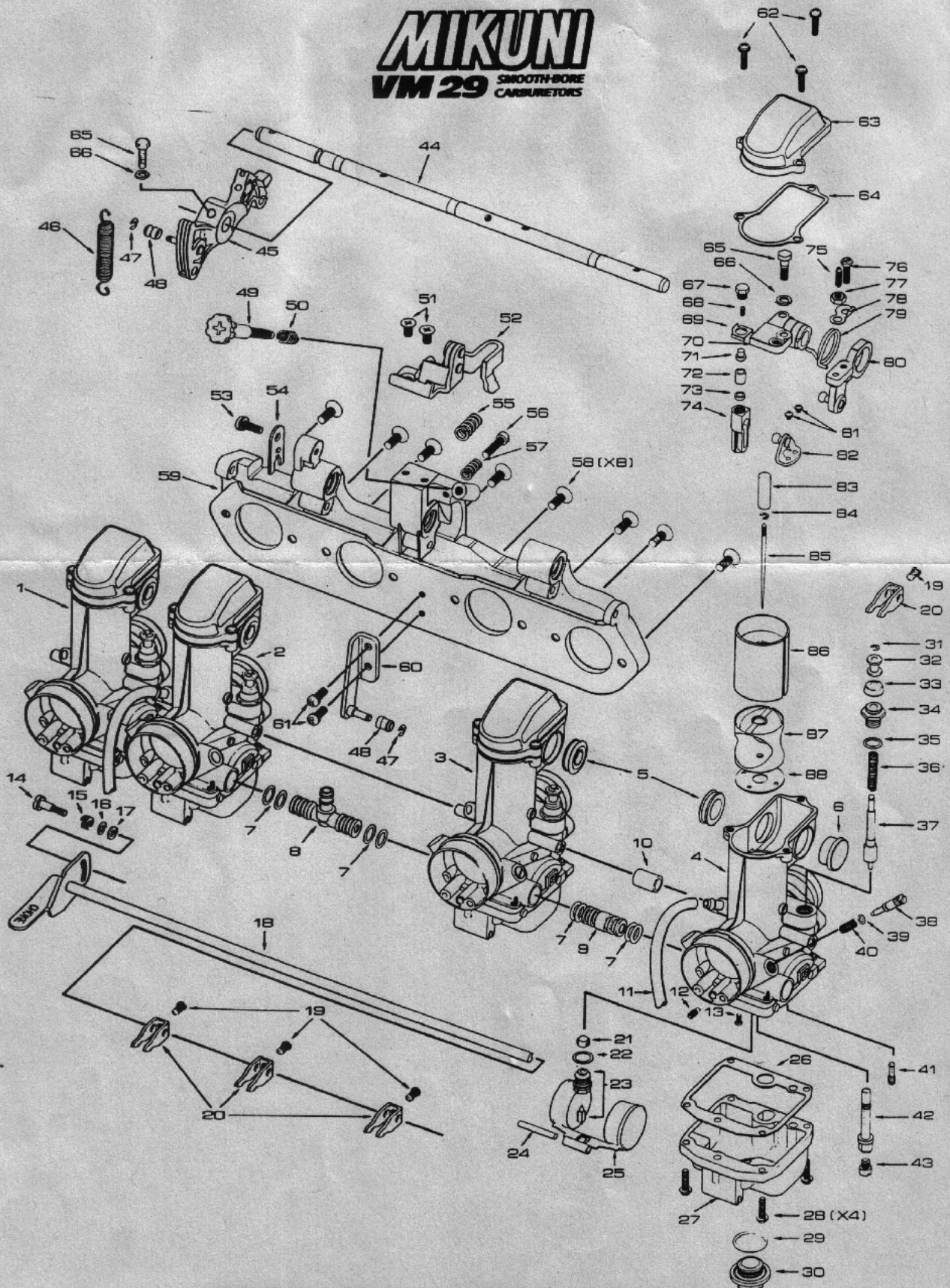

AMERICAN PERFORMANCE ENGINEERING
BOX 6998 1010 W OAK ST. BURBANK, CA. 91510

1-818-842-4952

MIKUNI

VM 29 SMOOTH-BORE
CARBURETORS

| ITEM NO. | ORDER NO. | MIKUNI PART NO. & DESCRIPTION | ITEM NO. | ORDER NO. | MIKUNI PART NO. & DESCRIPTION |
|----------|-----------|--------------------------------|----------|-----------|----------------------------------|
| 1. | NA | VM29SS1/01b Mixing Body | 46. | 002-521 | VM24/536 Spring, Thr. return |
| 2. | NA | VM29SS2/01b Mixing Body | 47. | 002-355 | BSW28/70 E-ring |
| 3. | NA | VM29SS3/01b Mixing Body | 48. | 002-663 | VM24/532 Ring, Thr. lever |
| 4. | NA | VM29SS31/01b Mixing Body | 49. | | VM26/436 Screw, idle adjusting |
| 5. | 002-510 | VM24/489 Seal, Rubber | 50. | | BNO42/31 Spring, idle adjusting |
| 6. | 002-509 | VM28/559 End cap, Rubber | 51. | 002-637 | C5=0510 Screw, bracket |
| 7. | 002-617 | BV30/40 O-ring | 52. | 002-505 | VM24/466 Bracket, throttle cable |
| 8. | | VM26/268 Fuel joint (T) | 53. | 002-516 | CW2=0514-B Screw w/lockwasher |
| 9. | | VM26/269 Fuel joint | 54. | 002-517 | VM28/498 Plate |
| 10. | 002-379 | VM26/308 Hose, rubber (16mm) | 55. | | BN38/341 Spring, Shock |
| 11. | | VM15/217 Hose, Rubber air vent | 56. | | N115.053 Screw, Throttle Adj. |
| 12. | | BS30/97 Air jet | 57. | 002-655 | N110.209 Spring, Throttle Adj. |
| 13. | | CW2=0307 Screw w/lockwasher | 58. | | C5=0614 Screw |
| 14. | 002-666 | VM28/269 Screw (Starter Lvr) | 59. | 002-507 | VM24/460 Back plate |
| 15. | 002-665 | VM28/293 Spring (Starter Lvr) | 60. | 002-533 | VM24/513 Bracket, Throttle Sp. |
| 16. | 002-664 | VM28/449 Washer (steel) | 61. | 002-516 | CW2=0514-B Screw w/lockwasher |
| 17. | 002-613 | VM28/268 Washer (nylon) | 62. | 002-522 | CW2-0414 Screw w/lockwasher, top |
| 18. | 002-511 | VM24/462 Shaft, starter | 63. | 002-523 | VM24/507 Mixing Chamber Top |
| 19. | | VM28/360 Screw (Starter Lvr) | 64. | 002-524 | VM28/549 Gasket, M.C. Top |
| 20. | 002-660 | VM26/435 Starter Lever | 65. | 002-519 | VM28/230 Bolt |
| 21. | 002-606 | VM18/233 Filter | 66. | 002-520 | W4=05-B Lockwasher |
| 22. | 002-187 | B34/52 0.5 Washer, Valve seat | 67. | | VM29/04 Cap screw |
| 23. | 002-503 | N122.032 2.5 Needle Valve | 68. | | B21/29 Spring |
| 24. | 002-107 | BV26/22 Float pin | 69. | | VM28/233 Lockwasher plate. |
| 25. | 002-501 | VM26/260 Float assembly | 70. | 002-532 | VM28/554 Lever, Pull |
| 26. | 002-502 | VM26/258 Gasket, Fl. Chamber | 71. | | VM28/195 Pin (Top) |
| 27. | 002-525 | VM29/20-100 Float Chamber | 72. | | VM29/05 Pin (Bottom) |
| 28. | 002-615 | CW2=0416-B Screw w/lockwasher | 73. | | VM29/06 Plate |
| 29. | 002-531 | VM28/254 O-Ring (Drain plug) | 74. | | VM29/07 Connector |
| 30. | 002-526 | VM28/253 Drain Plug | 75. | 002-508 | VM28/593 Adjusting Screw |
| 31. | 002-673 | KP/13 E-clip (Str. Plunger) | 76. | | B2=0416 Bolt, Link lever |
| 32. | 002-674 | VM28/450 Bushing, Nylon | 77. | | N3=05 Nut |
| 33. | 002-084 | VM20/455 Cap, rubber | 78. | | VM28/594 Plate, Set |
| 34. | 002-675 | VM28/359 Fitting, Str. Plunger | 79. | | VM28/592 Spring |
| 35. | 002-672 | VM18/249 O-ring, Str. Plunger | 80. | 002-528 | VM29/17 Link lever assembly |
| 36. | 002-671 | VM16/42a Spring, Str. Plunger | 81. | 002-527 | CW2=0305 Screw w/lockwasher |
| 37. | | VM24/510 Starter Plunger | 82. | 002-530 | VM29/08 Bracket, connecting |
| 38. | 002-506 | VM26/288 Pilot air screw | 83. | 002-515 | VM29/14 Pin, Needle retaining |
| 39. | 002-676 | VM14/75 O-ring | 84. | 002-083 | VM20/369 E-Ring |
| 40. | 002-181 | M12F/46a Spring, pilot screw | 85. | 002-268 | J8-5DL31 Jet Needle |
| 41. | | VM22/210 Pilot Jet | 86. | | VM29/15 Throttle Valve |
| 42. | | VM29/16 Needle Jet (261) | 87. | 002-500 | VM29/10 Jet Block |
| 43. | | N100/604 Main Jet | 88. | 002-535 | VM29/13 Gasket, Jet Block |
| 44. | 002-513 | VM29/11 Throttle shaft | 89. | | VM33/78 Warning Tap |
| 45. | 002-518 | VM24/533 Lever, throttle | | | |